



HAND BRAKES

HBT
SERIES



MODEL
HBT48-12
HBT72-16
HBT96-16



MODEL HBT72-16

TENNSMITH's new HBT72-16 is designed to provide forming capabilities for complex parts. This machine is truly a universal hand brake, which allows for the removal of both upper and lower segments of fingers. Complex parts, such as HVAC transverse duct forming and down flanged parts, as well as architectural sheet metal and signage applications, can easily be formed using this machine.

The HBT72-16 is built with the same high-quality features and standards that TENNSMITH brakes are recognized for throughout the industry. Please consult TENNSMITH for specific forming questions or applications.

- FOLDING SYSTEMS
- SHEARS
- HAND BRAKES
- SLIP ROLLS
- ROTARY MACHINES
- CLEAT BENDERS
- CHEEK BENDERS
- NOTCHERS

HAND BRAKE

	HBT48-12	HBT72-16	HBT96-16
Capacity, mild steel	12 gauge/2.7 mm	16 gauge/1.6 mm	16 gauge/1.6 mm
Capacity, with bending support angle removed, mild steel	16 gauge/1.6 mm	20 gauge/1.0 mm	20 gauge/1.0 mm
Bending length	48 in/1220 mm	72 in/1828.8 mm	97 in/2464 mm
Maximum lift of beam	1-1/2 in/38.1 mm	1-1/2 in/38.1 mm	2-1/4 in/57 mm
Front to rear beam adjustment	1/2 in/13mm	1/2 in/13mm	1/2 in/13mm
Maximum depth of box	4 in/101.6 mm	4 in/101.6 mm	4 in/101.6 mm
Minimum reverse bend	5/8 in/16mm	5/8 in/16mm	5/8 in/16mm
Minimum flange in capacity material	1 in/25 mm	1 in/25 mm	1 in/25 mm
Top segment tooling widths	2, 3, and 4 in 50.8, 76.2 and 101.6 mm	2, 3, and 4 in 50.8, 76.2 and 101.6 mm	2, 3, and 4 in 51, 76 and 101 mm
Lower segment tooling widths	1, 1-1/2, 4, 6, 8, 12, 20 in 25, 38, 102, 203, 305, 508 mm	1, 1-1/2, 4, 6, 8, 12, 20 in 25, 38, 102, 203, 305, 508 mm	1, 1-1/2, 4, 6, 8, 12, 20 in 25, 38, 102, 203, 305, 508 mm
Bending beam tooling segments	1, 1-1/2, 4, 6, 8, 12, 20 in 25, 38, 102, 203, 305, 508 mm	1, 1-1/2, 4, 6, 8, 12, 20 in 25, 38, 102, 203, 305, 508 mm	1, 1-1/2, 4, 6, 8, 12, 20 in 25, 38, 102, 203, 305, 508 mm
Max. traverse bend (through tooling centers)	2 in/50.8 mm	2 in/50.8 mm	2 in/50.8 mm
Max. traverse bend (at either end of the machine)	3 in/76.2 mm	3 in/76.2 mm	3 in/76.2 mm
Dimensions, counterweights in place, LxWxH	72 x 36 x 53 in 1829 x 915 x 1346 mm	89-1/2 x 36 x 53 in 2273 x 915 x 1346 mm	120 x 36 x 53 in 3048 x 915 x 1346 mm
Shipping weight	1750 lbs/795 kg	2200 lbs/1000 kg	2500 lbs/1140 kg

Available options: Radius fingers

MANUAL REQUEST [▶▶](#)

TECHNICAL SUPPORT [▶▶](#)

REQUEST CATALOG [▶▶](#)

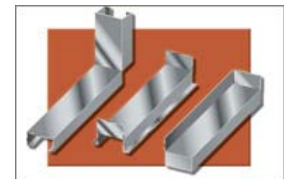

Sample bends achieved with HBT72-16.



SCOTT
MACHINERY

Ph. (916) 638-7718
Ex. (916) 638-2450
Email: sales@scottmachinery.com
4700 Lang Avenue, Suite D
McClellan, CA 95652